

Cable management

Cable entry



Cable entry grommets

In conjunction with the cable entry plate, simple and fast sealing of cables inserted in the base area of enclosures.

Material:

Body: Polypropylene
Cover: Thermoplastic elastomer

Protection category:

IP 55 subject to correct mounting.

Cables per grommet	Max. Ø mm	Packs of	Model No. PS
8	13	25	4316.000
3	21	25	4317.000
1	47	25	4318.000

German patent no. 42 07 281
European patent no. 0560119
with validity for FR, GB, IT, NL
Japan. patent no. 2533052
US patent no. 5,422,436



Connector grommets

Suitable for cable diameters from 8 to 36 mm.

Material:

Outer cover: Polypropylene covered with thermoplastic elastomer
Seal: Cellular rubber

Protection category:

IP 55 subject to correct mounting.

Packs of	Model No. PS
10	4311.000

German patent no. 44 05 328
Italian patent no. 0 127 3503
French patent no. 2 716 583

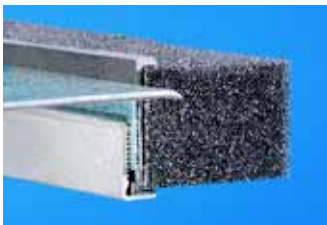

Section for cable entry, centre for TS, CM, TP, FR(i)

For top-mounting on gland plates. A superior alternative to the foam rubber cable clamp strip, thanks to:

- Easier mounting
- Full-surface support
- High level of sealing of cables inserted into the enclosure

Material:

Extruded aluminium section, seal PU foam, cross-section: 30 x 25 mm

Protection category:

IP 55 subject to correct mounting.

Note:

1 set is sufficient for one base opening up to an enclosure width of 800 mm. From an enclosure width of 1000 mm, two base openings are provided. 2 sets per enclosure may be fitted.

For enclosure width mm	Packs of	Model No. TS
600	1 set	8802.060
800	1 set	8802.080
1000	2 sets	8802.100
1200	2 sets	8802.120
1600	2 sets	8802.160



Accessories:

Cable clamp rail (right angle section), see page 1061.
C rail, see page 999.

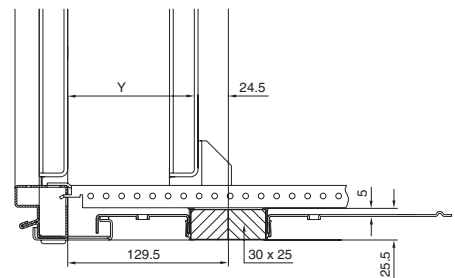

Y = Mounting plate depth-adjustable on a 25 mm pitch pattern (final pitch 30 mm).